

①Preparation before install the chair

- 1.Open the package of main body, take out the back rest and put aside.
- 2.Open up the calf leather cover, pull out the two bolts which has fixing straps, then lift the calf, pull out the hinge pin, like illustration 4,put the calf aside.
- 3.Take out front cover cloth from the chair.

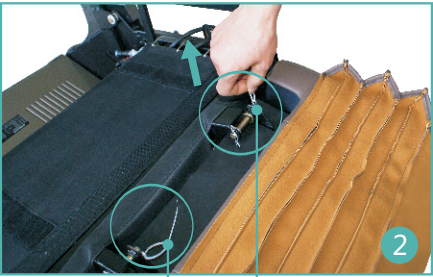

Fixing Bolt ps

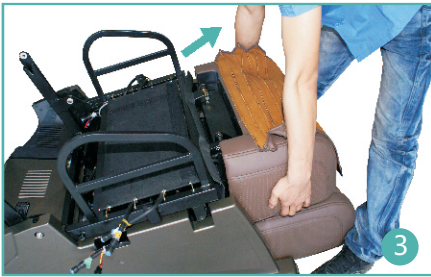

Front cover cloth

②Install armrest

- 1.Open the package of armrest, take out the armrest from carton, take the left armrest for example.
- 2.Insert the air pipe and data wire with seat outlet. (There has numbers corresponding).
- 3.Fix the armrest with seat, and install screw nuts corresponding, use with M8X45, M8X16 hex screws joint firmly.
- 4.Fix the sliding pin with the holes on seat, lock them with hex screws.
- 5.Do the same with right armrest.

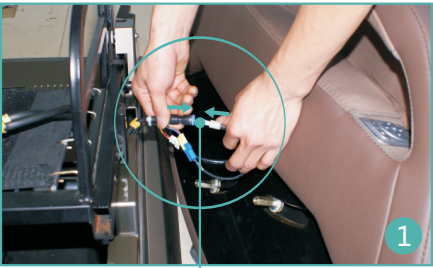

Air pipe and data wire

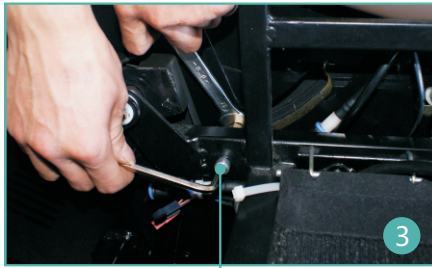
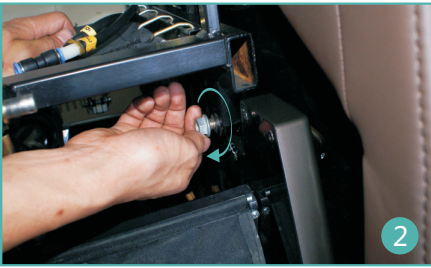

Inner hexagon screw

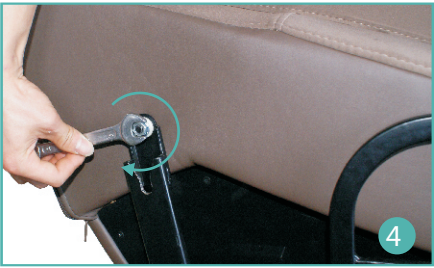

③Install Hip Air Massage Bags

- 1.Take the left hip air bag for example, move the rubber band on the air pipe, then insert the air pipe with seat corresponding the numbers.
- 2.Send the air pipe on the hip air bags after make straight, pass the self-sticking strap from the steel pipe, meanwhile put the hip air bag to the bottom, stick the self-sticking strap on the seat.
- 3.Do the same with right hip air massage bags.

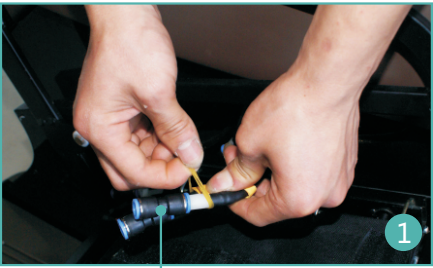

Air Pipe

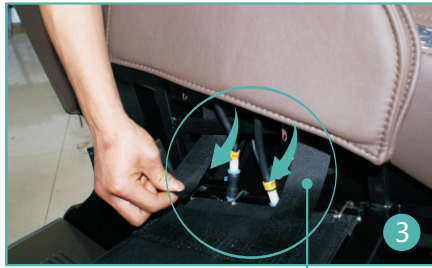
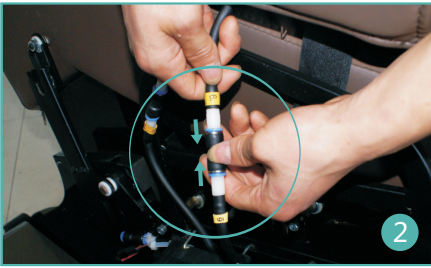

Self-sticking strap



④Install the back rest

- 1.1.Insert the spindle on two sides of backrest to the U shaped grooves on the seat.
- 2.Insert the data wire with the electric control box, from the under of the front of the seat will insert the wires easily.
- 3.1.Insert the air pipe from backrest with air pump box correspond the numbers.



Rotating stand

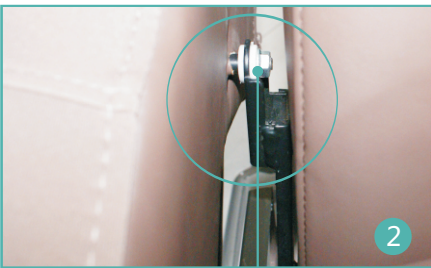

Spindle

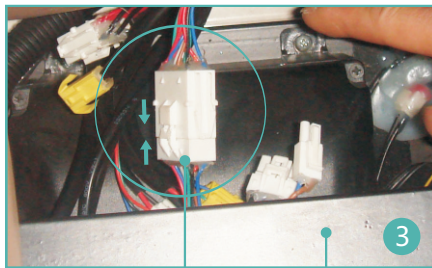

Data wire Seat



Trachea

⑤ Install footrest

- 1.Put the front cover cloth on the seat.
- 2.Lift the footrest and hang it in the seat connecting shafts, insert the two bolts which has fixing strap, cut the strap after done.
- 3.Stick connecting leather coat of footrest on the seat.



Front cover cloth

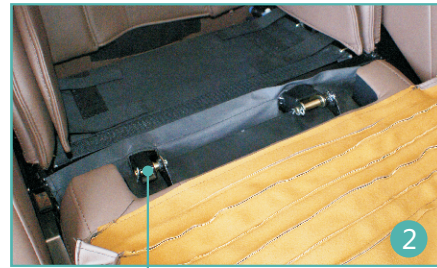

Seat connecting shafts

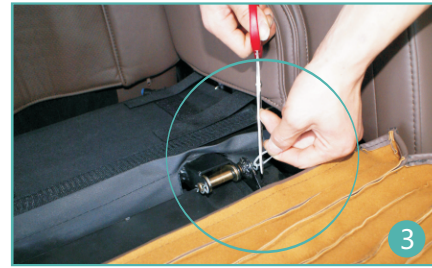

Footrest connecting leather coat

⑥ Install seat cushion

- 1.Insert the seat cushion air pipe and data wire firmly with seat base correspondingly.
- 2.Keep the air pipe straight, send them under the seat, then stick the seat cushion on seat base.

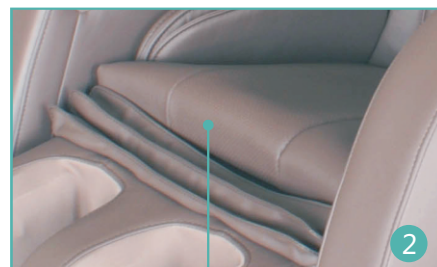

Seat cushion

⑦ Install shoulder air massage units

- 1.Move the fixing strap on the air pipe of backrest shoulder position, insert the shoulder air massage unit air pipe with backrest correspondingly, make sure insert firmly and in position.
 - 2.Keep the air pipe straight, then send them into backrest.
 - 3.Aligning shoulder air massage unit screw holes with backrest, use two M8X25 inner hexagon screws to lock them.
 - 4.Fix the leather cover after installed the shoulder unit, do the same with other side.
- Please distinguish Left and Right units carefully, the shape of "L" should face inside, the upper round corner is a little big.



Shoulder air massage unit



Socket head wrench

⑧ Install small pillow

- 1.Insert the small pillow air pipe with backrest firmly.
- 2.Adjust the height of small pillow as personal need, stick the pillow on backrest.



Self-sticking strap

⑨ Install controller hold

- 1.Insert the controller hold, turn the knob to lock.



Manual Knob